



**NEWTON EARLY CHILDHOOD PROGRAM  
687 WATERTOWN STREET**

**PUBLIC FACILITIES COMMITTEE HEARING**

Newton Public Schools  
Newton, Massachusetts

JUNE 5, 2019

**ARROWSTREET**

10 POST OFFICE SQUARE  
SUITE 700N  
BOSTON, MA 02109  
617.623.5555

[www.arrowstreet.com](http://www.arrowstreet.com)

**Hill International**

75 SECOND AVENUE  
SUITE 300  
NEEDHAM, MA 02494  
617.778.0900

[www.hillintl.com](http://www.hillintl.com)





687 Watertown Street





## Newton Early Childhood Program (NECP)

### City Wide Integrated Pre School Educational Program

- » Program currently located at former Aquinas College (150 Jackson Road)
- » Serves ages 2.9 years old to under 6 years old
- » Classroom based and related services provided to students
- » Approximately 65 - 70% of NECP students have Individualized Education Plans (IEPs)
- » Due to the nature of the program, enrollment increases throughout the school year
- » The NECP group size for integrated classrooms is limited to a total of 16 students per classroom; two sub-separate classrooms have a limit of 9 students

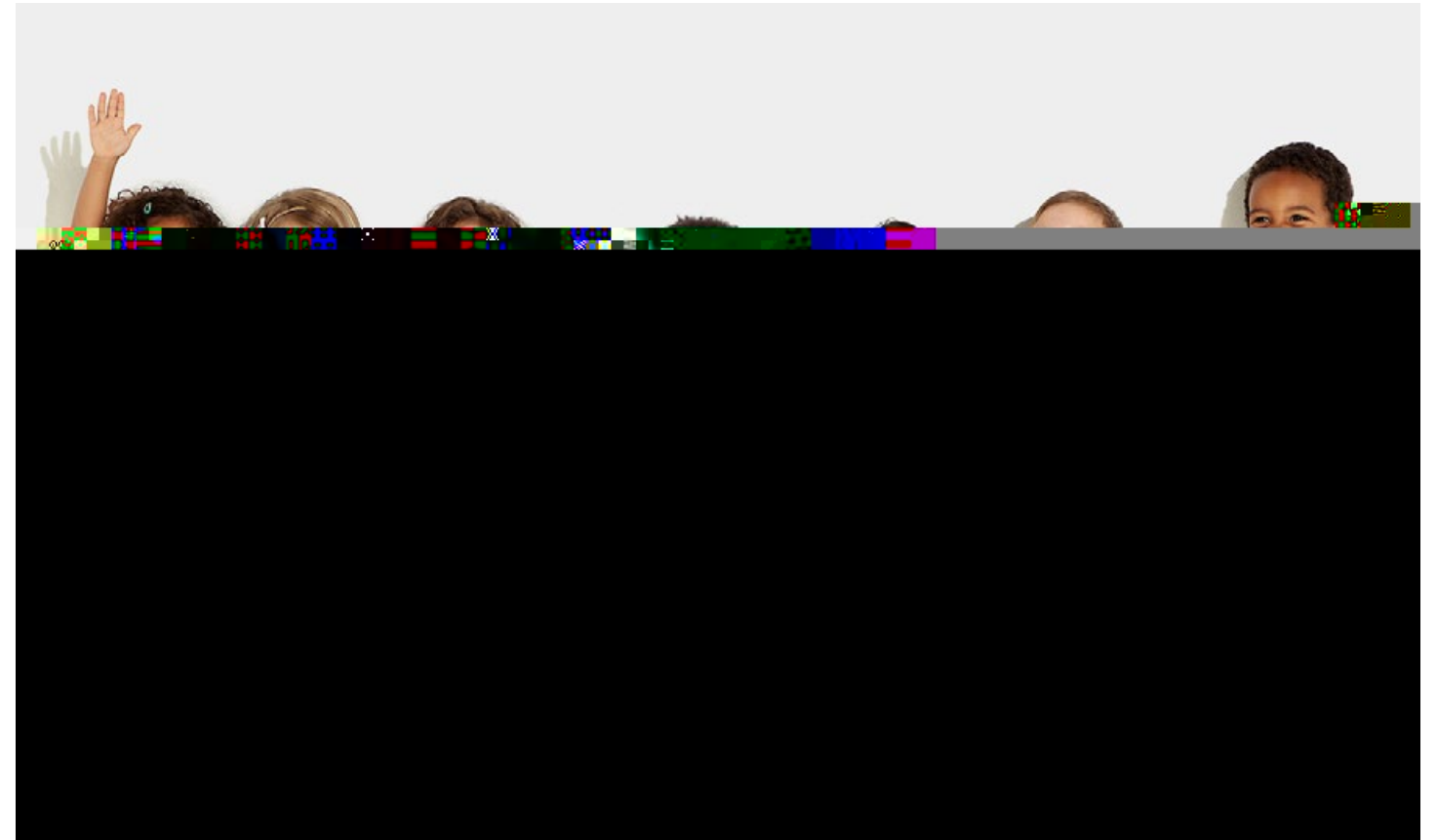

# Program Summary and Design Guidelines

Projected NECP at 687 Watertown Street

## Exterior/ Site

- » Outdoor age appropriate playground
- » Car-centric due to nature of program
- » Vans operation: 12 - 15 Vans
- » Parent/ guardian vehicles: 45 - 65
- » Staff vehicles: 85 - 100

## Building/ Program

- » Building Size: 38,000 SF on 3 levels
- » Remove modulars
- » Occupancy:
  - 305 total students (ages 2.9 to under 6 years old)
  - 104 Special needs
  - 90 Typically developing
  - 111 Related services85 - 100 Staff
- » Hours of Operation:
  - Entry 8:30am to 9:00am
  - Dismissal 12:00 to 12:30pm, 1:30pm, and 2:30pm
- » 14 - 18 Classrooms

## Features/ Goals

- » Improve pick-up/ drop off and entry to provide access and security for families and caregivers
- » Design with regard with understanding the mobility and sensory needs of population
- » Design for inclusiveness and spaces for specialists adjacent or within classrooms
- » Create shared specialist offices to foster collaboration and sharing between teachers

## NECP Site Circulation

### Unique Features to the City wide Integrated Preschool Program

- » No yellow buses
- » Students are **2.9 to under 6 years old**, which are escorted into and picked up at the classroom
- » All transportation provided by NPS is required to be door-to-door specialized van services
- » **70 - 110 students** are transported by specialized vans, increasing throughout the year
- » At peak times, there are **10 - 12 specialized vans** required to pick up students
- » Specialized vans, just like yellow buses, require **full traffic stop** while loading and unloading students
- » All students arriving by specialized van transportation are in **5-point restraint booster seats**, requiring additional loading and unloading time
- » The NECP school schedule has **varied times and schedules** (e.g., half day, afternoons only, services only)
- » There are **two scheduled van drop off times** in the morning
- » Drop offs and pick-ups are scheduled every **15-30 minutes** from noon to 2:30 p.m.
- » **Role model students** arrive with and are picked by parents/ guardians (mostly arriving by car)
- » Proximity of **Day Middle School** adds to potential peak traffic congestion/delays for specialized vans along Albemarle Road

# 687 Watertown Street

## NECP Parking Plan

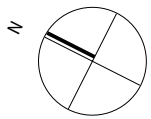

» Projected parking demand:

- 85 - 100 Staff
- 45 - 65 Parents/ Guardians

» Available parking:

- (Approx. 265 total existing)
- 18 parking lot (Staff)
- 93 head in east side of Albemarle down to Gath
- 72 parallel on west side of Albemarle down to Gath
- 80+ parallel on Edinboro, Page, Walker, Brookside, and Albemarle (South of Watertown)

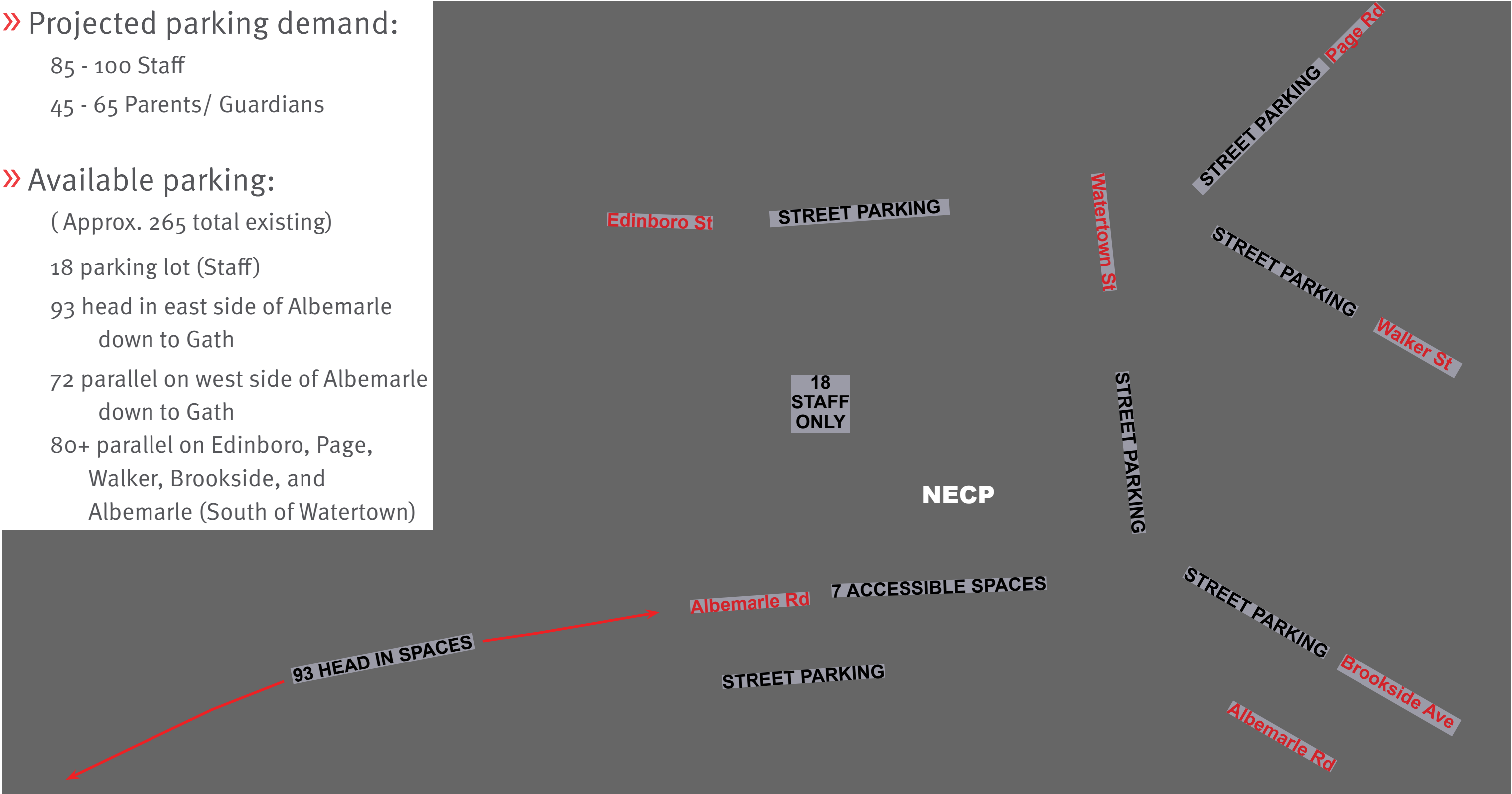

# Site Trip Generation Comparison

## Existing Horace Mann School vs. Proposed NECP

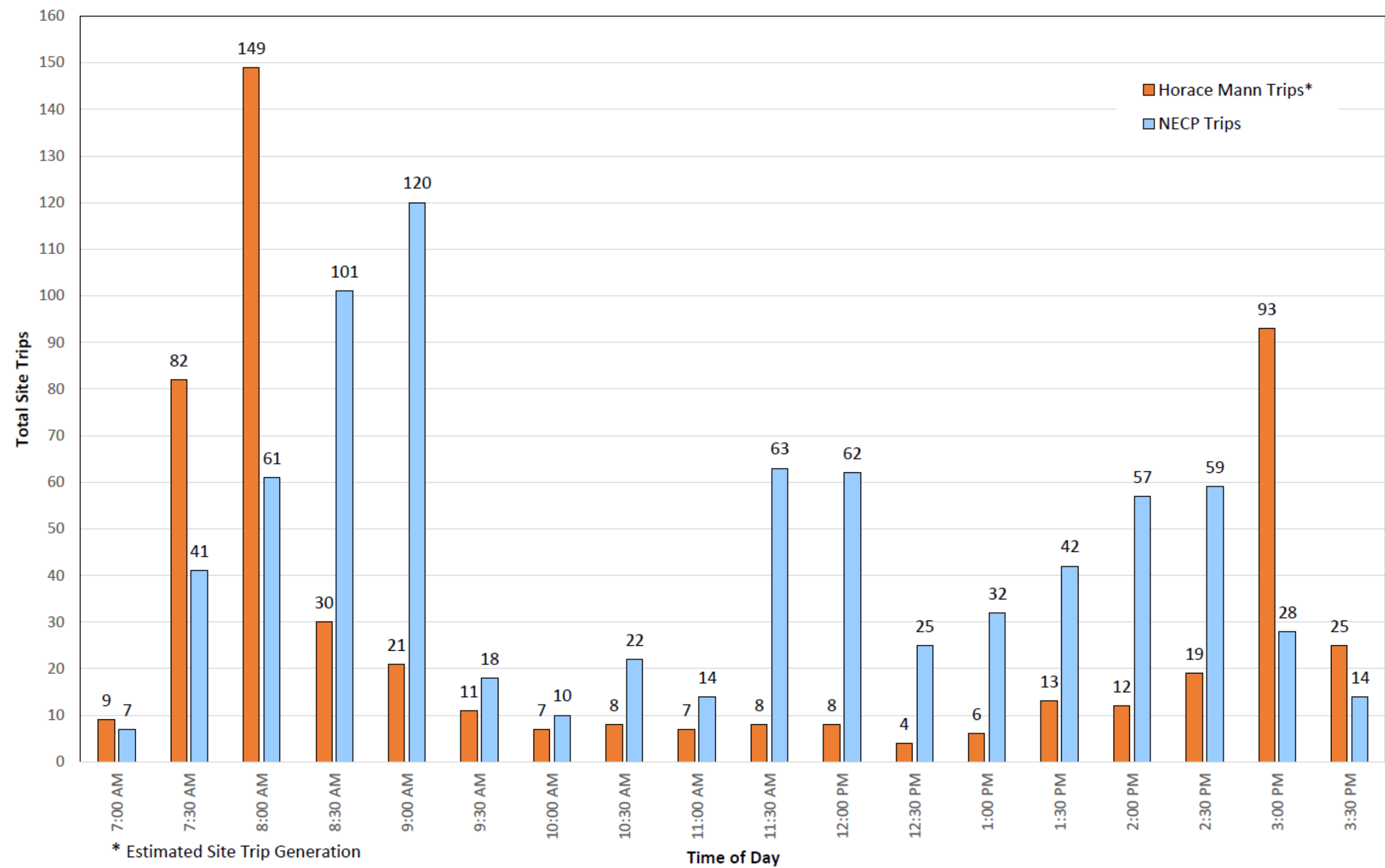



# 687 Watertown Street Site Circulation

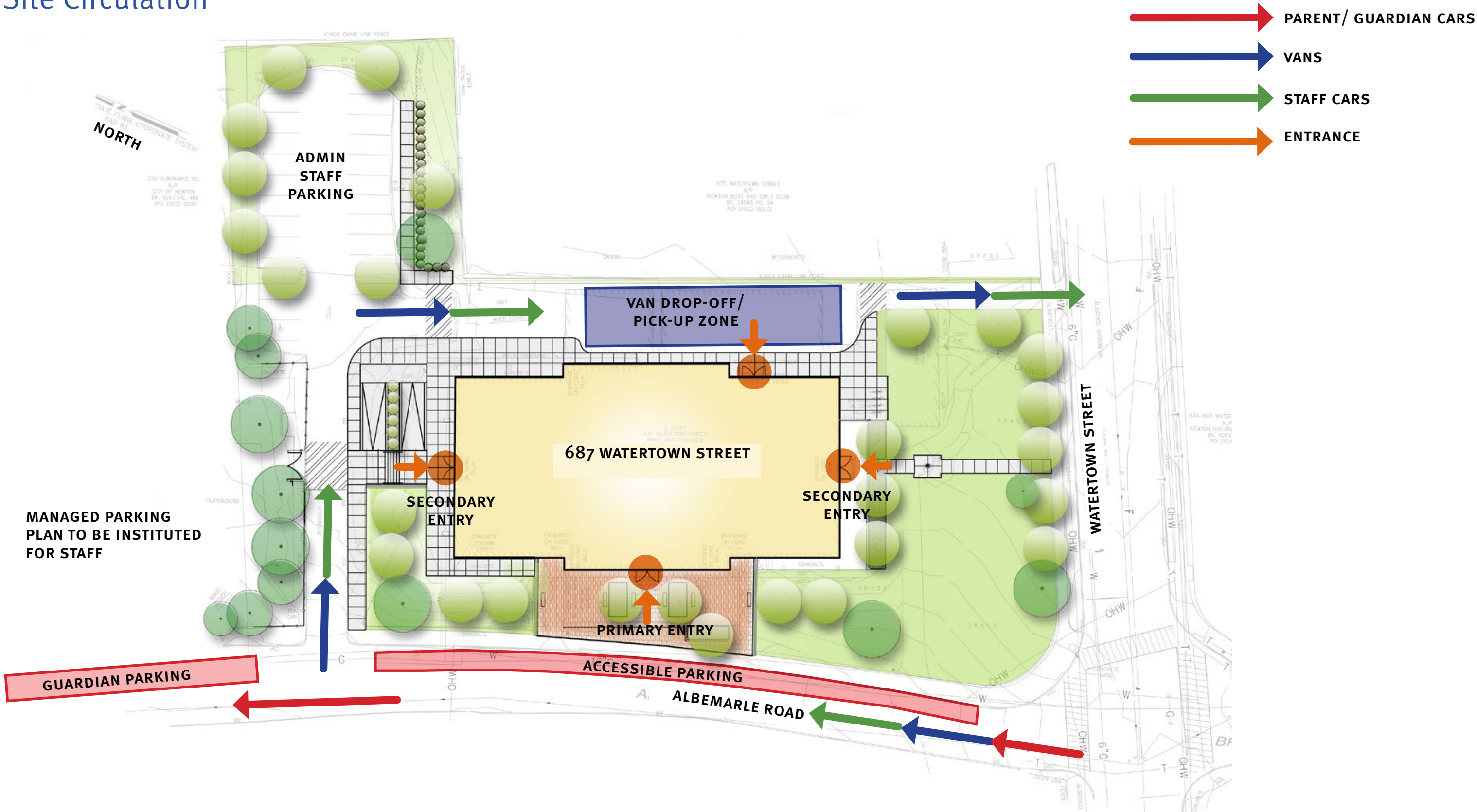



## 687 Watertown Street Developed Option

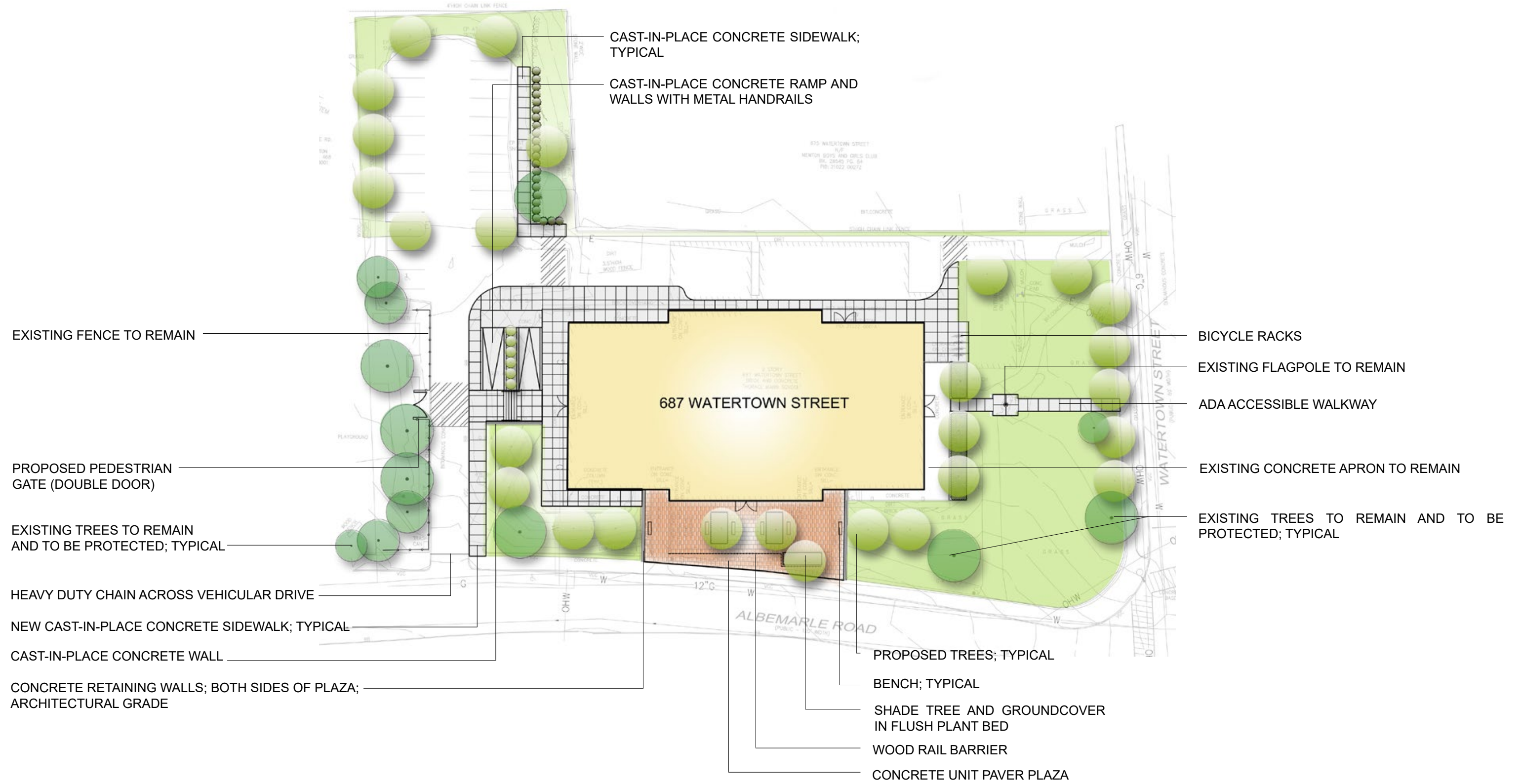



# 687 Watertown Street Playground Concept



RUBBER SURFACING EXAMPLES



EQUIPMENT FROM 150 JACKSON





# Newton Early Childhood Program

## Lower Level (Level o) – Fit Plan

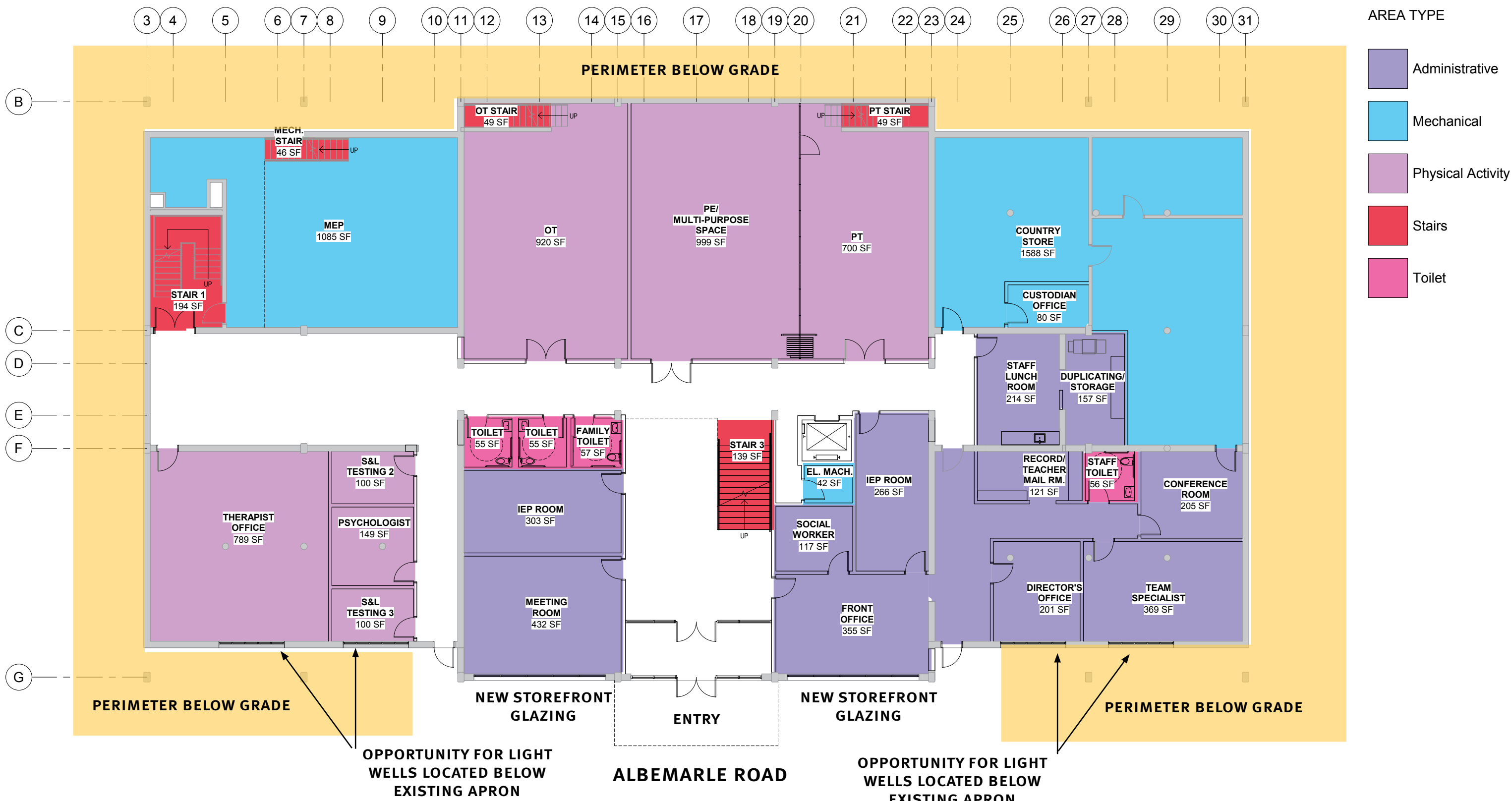

# Newton Early Childhood Program

## Middle Level (Level 1) – Fit Plan

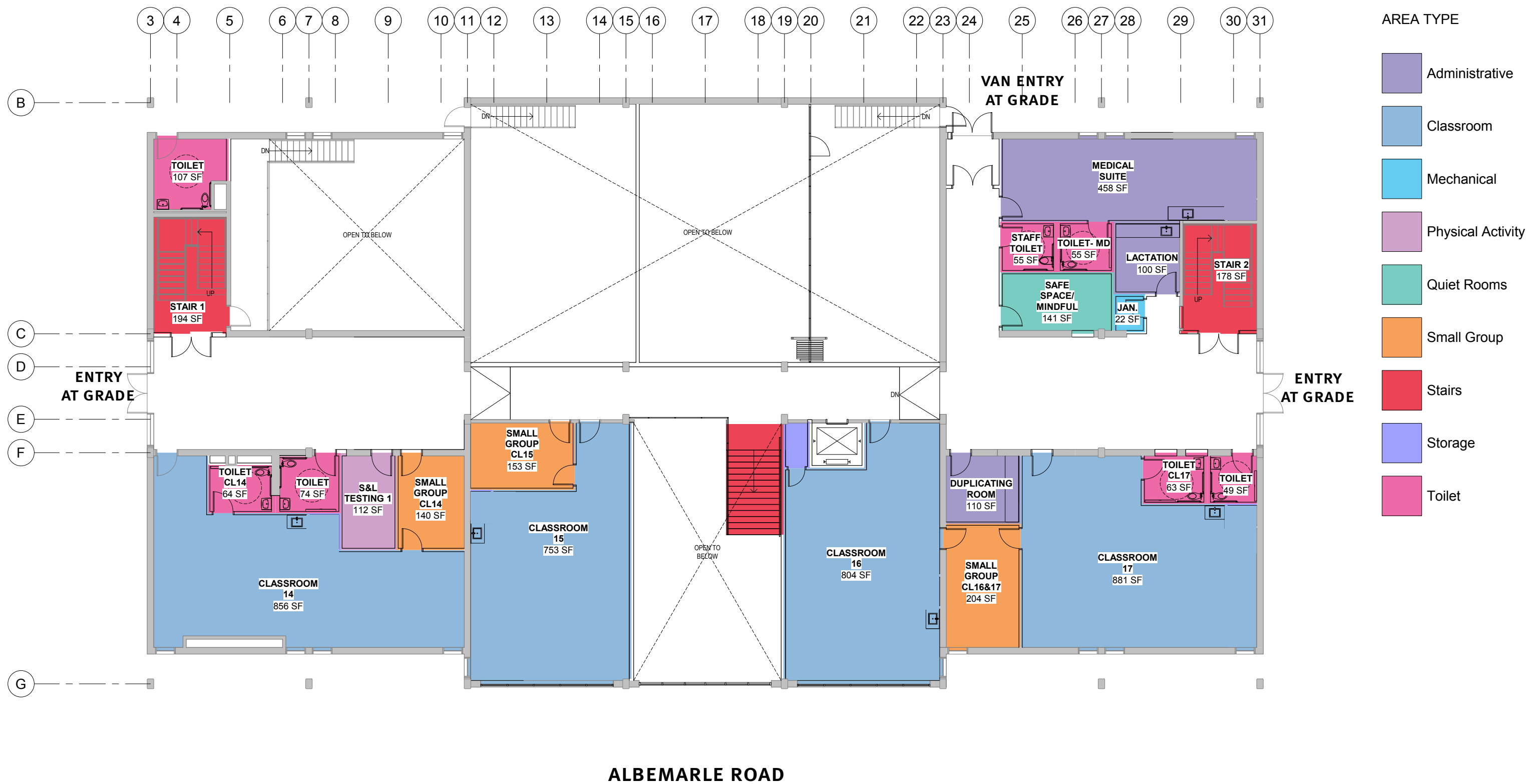



# Newton Early Childhood Program

## Upper Level (Level 2)– Fit Plan

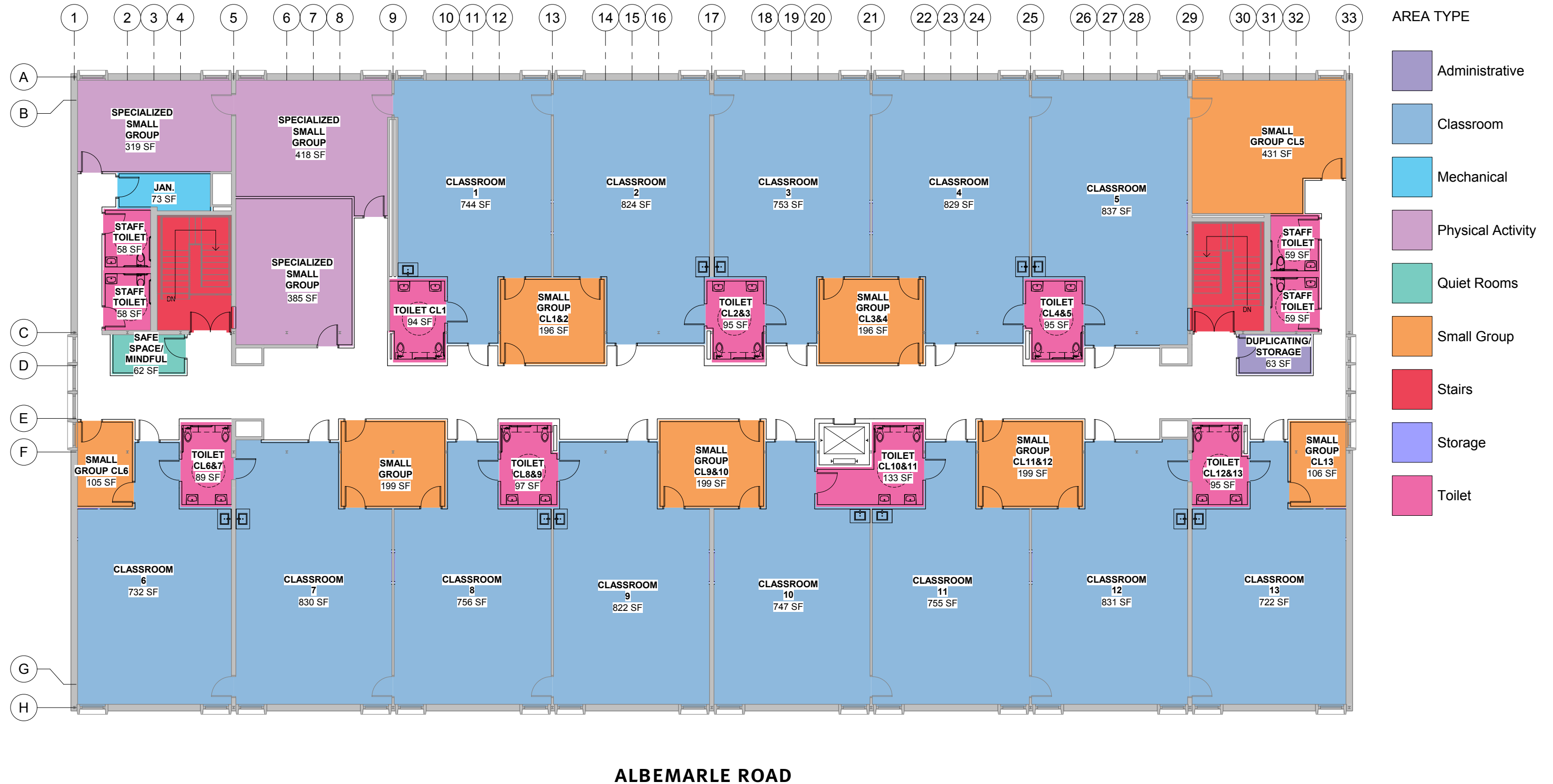

## Project Websites

[www.newtonma.gov/gov/building/capital\\_projects](http://www.newtonma.gov/gov/building/capital_projects)

[www.lincolneliot-necp-projects.com](http://www.lincolneliot-necp-projects.com)

**NEWTON EARLY CHILDHOOD PROGRAM**  
**687 WATERTOWN STREET**

**PUBLIC FACILITIES COMMITTEE HEARING**

Newton Public Schools  
Newton, Massachusetts

JUNE 5, 2019

**ARROWSTREET**  
10 POST OFFICE SQUARE  
SUITE 700N  
BOSTON, MA 02109  
617.623.5555

[www.arrowstreet.com](http://www.arrowstreet.com)

**Hill International**  
75 SECOND AVENUE  
SUITE 300  
NEEDHAM, MA 02494  
617.778.0900

[www.hillintl.com](http://www.hillintl.com)